

RUBBA-RUBBA1000



Ejection rubber cutting made easy

RUBBA-RUBBA1000

The cutting table for die ejection rubber.



- ☞ Serviform diemaking tailored software interface
- ☞ Rubbasave software for reusing waste rubber pieces
- ☞ Automatic rubber cutting
- ☞ Unbeatable savings
- ☞ Low maintenance costs
- ☞ Industrial vacuum cutting area

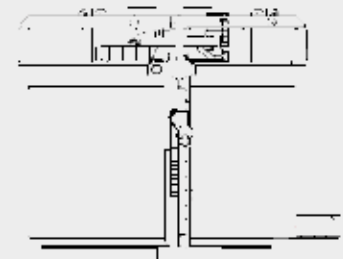
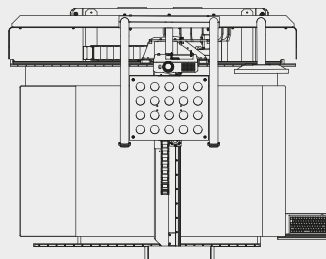
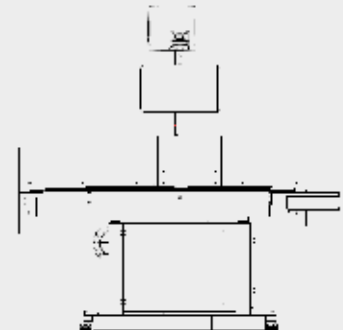
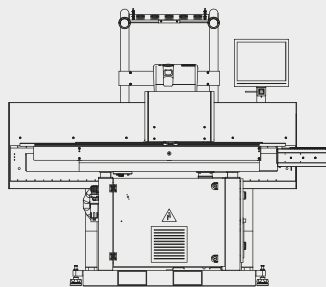

RUBBA

RUBBA1000

The quality of your dies and die cutter running speeds are more and more connected with the consistent design of the ejection rubber from blank to blank.

01

Until now, water jet cutting systems supplied satisfactory quality but at the sacrifice of high annual maintenance cost and extensive drying times.

02

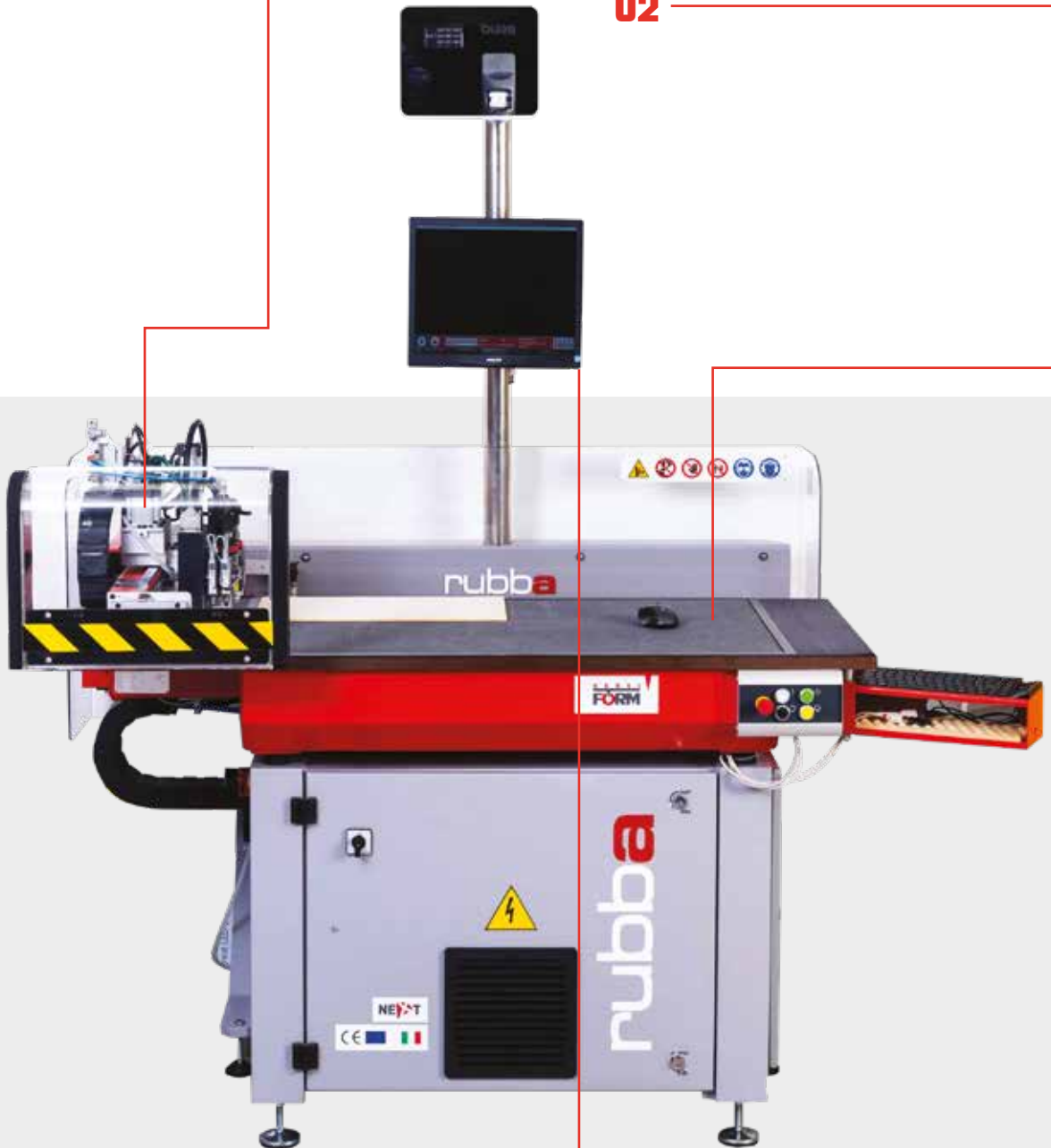

The RubbA and RubbA 1000 with its mechanical oscillating blade system was expressly developed for the die making industry. The RubbA and RubbA1000 guarantees high quality rubber cutting for up to three shifts a day.

03

RubbA is supplied with a high luminosity projector which projects the cutting path and cut parts on the rubber sheet so the operator can easily reduce rubber waste.

04

Kiss cutting into a 0.004" PSA liner is possible due to the engineering and flatness of the vacuum table.

05

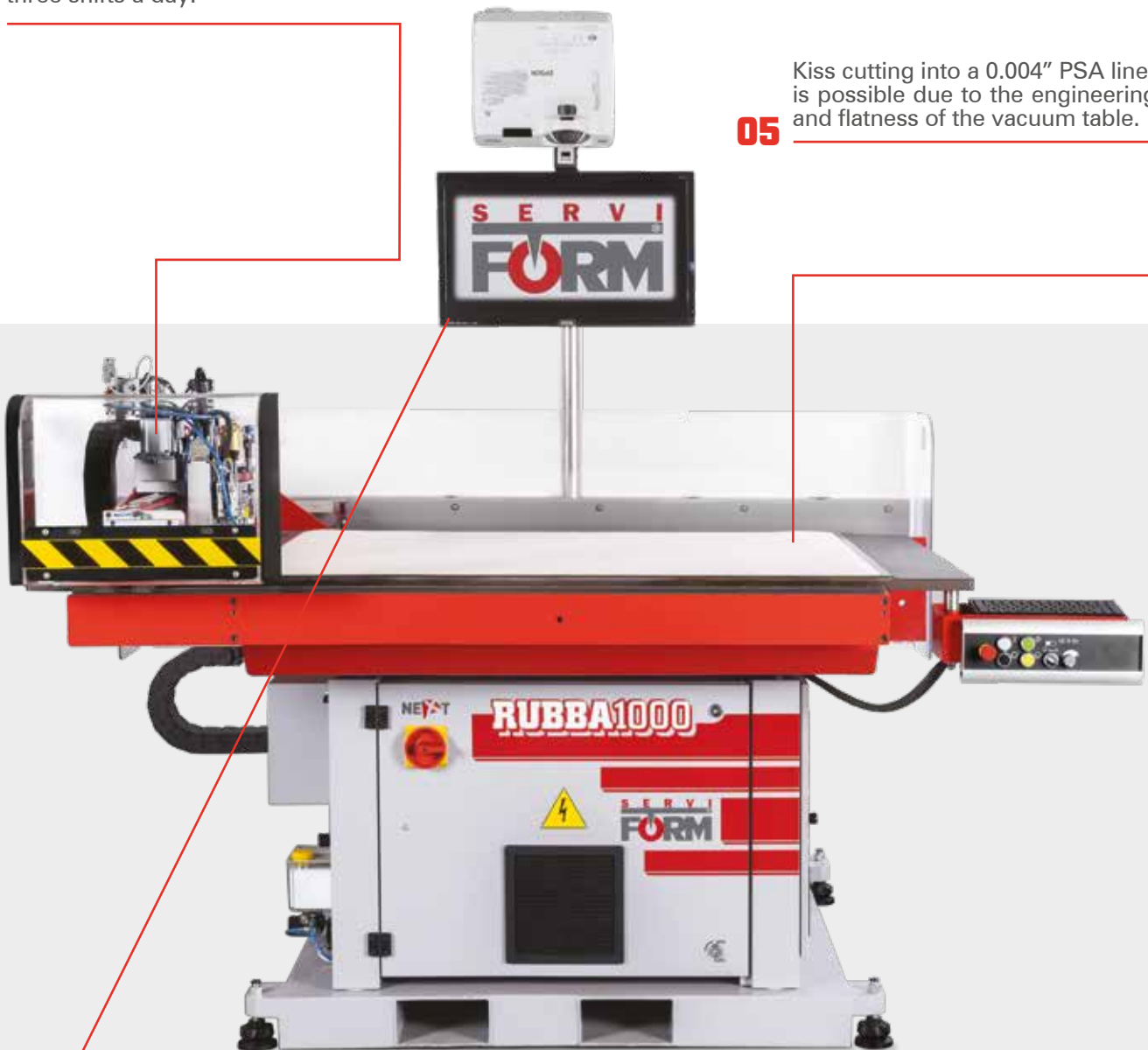

06

Waste material is eliminated through the revolutionary RubbaSave software developed by Serviform. The RubbA is supplied with a high-quality projector, which estimates cutting paths on the rubber sheet before actually making the cuts so the amount of waste per sheet is reduced.



Serviform America was formed in August of 2015, in partnership with Proform S.r.l the manufacturing division of Serviform, to provide a domestic parts and service organization for all Serviform machines in North America. In 2020, Serviform America added Cutlite Penta to their equipment arsenal and became the exclusive agent of Serviform equipment and Cutlite Penta Laser Systems in the United States and Canada. Serviform America is committed to providing customers with the highest level of service as well as a robust inventory of parts for Serviform benders, milling machines, rubber processors and Cutlite Penta flat, rotary and combo laser systems.

SERVIFORM

Numbers that count in Italy!



+60%

Increase of machines sold from 2009 to 2021



+60:

Employees



5

International patents



7%

Turnover reinvested in Research and Development annually



+4500 mq:

Office area and production departments



91%

Export turnover



+800

Companies using our machines



+60

Countries where we have machines installed



+650

Service and assistance hours per year



12

Research and Development active projects



72.400 kw:

Energy produced by Serviform photovoltaic park



+110

Customers visiting per year



1 mm:

Minimum bending radius



Accuracy

Dimension & weight

Power & consumption

Hardware:
X86 Compatible Windows

Data Input:
.DXF/ .DD3/ .DDS/ .CF2

Rapid Axis XYZ:
60 m/min

Work Speed:
max 30 m/min
(1181 inches/min)

Rubba
Machine Body:
1540x1235 h1885 mm
(60.63" x 48.62" x 74.20")

Rubba 1000
Machine Body:
2234x1761 h2004 mm
(87.95" x 69.33" x 78.89")

Rubba
Working Area:
1000x600 mm
(39.37"x23.62")

Rubba 1000
Working Area:
1200x1000 mm
(47.24"x39.37")

Rubba
Weight Machine Body:
440 Kg
(970 lbs)

Rubba 1000
Weight Machine Body:
840 Kg
(1851 lbs)

Power Supply:
400V/220V +/-10% 50/60hz 3P(+N)

Air Pressure:
9 bar (130 psi)

Rubba
Installed power:
5Kw

Rubba 1000
Installed power:
8.9Kw

Rubba
Advisable Power Connection:
16A

Rubba 1000
Advisable Power Connection:
32A

Average Air Consumption:
450 NI/min Lt/min (15 CFM)
Clean Dry Air

Technical specifications can change without notice

Serviform machines are proudly manufactured by Proform S.r.l.

6840 Meadow Lane, Alpharetta, GA 30005
Phone: 844.850.4732 Email: sales@serviformamerica.com

www.serviformamerica.com